

- LEGEND**
- SAS NAGAR BOUNDARY (GIS)
 - OTHER LOCAL PLANNING AREA
 - RESIDENTIAL
 - MIX USE 1
 - MIX USE 2
 - COMMERCIAL
 - W WHOLESALE CENTRE
 - E EXPO
 - INDUSTRY - TECHNOLOGY AND R & D
 - INDUSTRY AND WAREHOUSE
 - INSTITUTION
 - FOREST & OPEN SPACE
 - PARK
 - FLORAL MILE
 - WATER BODY
 - RIVER RESERVE
 - ROAD
 - AIRPORT FACILITIES
 - TRANSPORTATION
 - RAILWAY
 - UTILITY
 - RESERVE SITE
 - RURAL & AGRICULTURE
 - EXISTING / APPROVED DEVELOPMENT
 - EXISTING BUILT UP
 - EXISTING VILLAGE
 - EXISTING 132kV LINES
 - EXISTING 220kV LINES

PROJECT TITLE :
**MASTER PLAN
 DEVELOPMENT FOR
 GREATER MOHALI REGION**

CLIENT :
**GREATER MOHALI AREA
 DEVELOPMENT AUTHORITY (GMADA)**

CONSULTANT FOR MASTER PLAN :
JURONG Consultants Pte Ltd
 (a member of JURONG International)
 8 Jurong Town Hall Road
 #08-00 THE JTC SUMMIT
 Singapore 609434

SHEET TITLE :
**SAS NAGAR PLANNING AREA
 OVERALL LAND USE (YR 2031)**

PLANNER : SEETOH K C / RISHIBA PURI
 CHECKED : RISHIBA PURI APPROVED : SEETOH K C

DRAWN : SITI KHALID

SCALE : 1 : 25 000 (AO) DATE : 05 DECEMBER 2008

VERSION : 3 (PHASE 2 - NOVEMBER 2008)

PLAN : SAS NAGAR OVERALL LAND USE PLAN

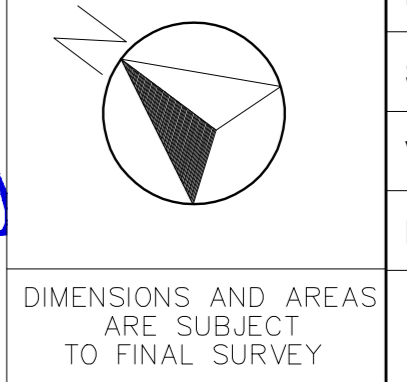
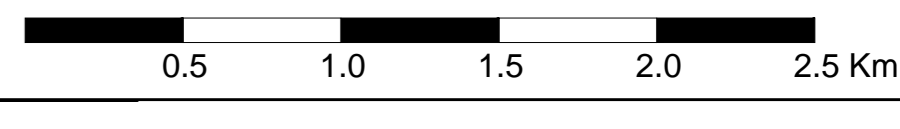

DIMENSIONS AND AREAS
 ARE SUBJECT TO
 FINAL SURVEY